



Synology Router

# RT1900ac

Designed for homes and offices, Synology Router RT1900ac broadcasts both 2.4GHz and 5GHz spectrums for combined data transfer speeds of up to 1900Mbps. Enjoy robust coverage with Beamforming and optimized multi-user performance, and fine-tune network traffic with Parental Control and Application Layer QoS. No more worries about router setting and management. Synology Router Manager (SRM) operating system provides you revolutionary user experience.

## Highlights

- **Simultaneous dual-band at 2.4GHz & 5GHz for up to 1900Mbps**
- **Robust coverage with Beamforming Support**
- **Application layer Quality of Service (QoS) allows total control of your network environment**
- **Intuitive Parental Control with built-in DNS-based web filter**
- **Revolutionary interface - Synology Router Manager (SRM) & DS router**
- **Perfect companion for your Synology NAS with Wake-on-LAN over QuickConnect**

## Fast, reliable Wi-Fi with Beamforming

Equipped with three powerful antennas and support for the latest 802.11ac wireless networking standard, **Synology Router RT1900ac** broadcasts both 2.4GHz and 5GHz spectrums for combined data transfer speeds of up to **1900Mbps**. Never worry about speed bottlenecks even when multiple devices are connected to the network.

Traditional routers broadcast wireless signals in all directions, regardless of the position of your laptop computer or mobile devices. With smart **Beamforming** technology, Synology Router RT1900ac focuses wireless signals toward up to six supported devices, reducing latency, economizing power consumption, and improving wireless range.

## Revolutionary software experience

**Synology Router Manager (SRM)** is the operating system that powers the Synology Router RT1900ac. With the friendly interface, it makes managing your network and Wi-Fi settings super simple, while delivering robust tools for power users and professionals.

- **Easy to use** - The familiar, desktop-like interface makes it easy for beginners to manage their entire network settings.
- **Convenient access** - To access SRM, simply aim your browser at "router.synology.com" during installation, or using a customizable QuickConnect ID, DDNS address to access SRM anywhere in the world.
- **Free updates** - Regular software updates means you can enjoy the newest features, technology, and security.

## Advanced management tools

With the **Network Center** application, you can limit bandwidth consumption, block malicious content, and fine-tune how data travels through your home or office network.

- **Traffic Monitor** - Intuitive and detailed graphical view on network resource allocation.
- **Application Layer QoS** - Allows you to have total control of the Internet availability by device and by networking applications.
- **Parental Controls** - Easily setup allowed time for each device with built-in DNS based web filter

## Access your files everywhere

By connecting a USB storage device or SD (SDXC) card to Synology Router RT1900ac, you can access its contents from anywhere or share files with family and coworkers. With complete support for all popular file protocols, including CIFS, AFP, FTP and WebDAV, Synology Router RT1900ac plays nice with Windows and Mac computers, as well as Android and iOS devices.

## Mobile apps ready for anywhere access

Install **DS router** on your Android or iOS device and conveniently manage Synology Router RT1900ac settings from the palm of your hand. DS router delivers robust tools and options, such as easy installation, wireless network management, real-time traffic monitoring and controls, and so much more. **DS file** can browse, open, and organize files that are stored on the USB storage device or SD card connected to Synology Router RT1900ac. With **DS download**, you can search for and start downloads tasks from anywhere, so they'll be finished by the time you return home.

## Technical Specifications

### Hardware

|                        |   |
|------------------------|---|
| CPU                    | Dual-core 1.0GHz  |
| RAM                    | DDR3 256MB  |
| Antenna type           | 3T3R Omni-directional high-gain dipole (2.4GHz / 5GHz)                |
| Antenna gain           | 2.4GHz 3.5dBi, 5GHz 4.6dBi  |
| LAN port               | Gigabit (RJ-45) x 4   |
| WAN port               | Gigabit (RJ-45) x 1   |
| External port          | USB 3.0 x 1 (5V, 1.5A power output)<br>SD card reader x 1(SDXC, SDHC) |
| Button and switch      | WPS, USB/SD eject, Power, Reset, Wi-Fi On/Off                         |
| Size (H x W x D)       | 66 mm x 206 mm x 160 mm (without antenna)                             |
| Weight                 | 0.51 Kg (with 3 antennas)   |
| AC input power voltage | 100V to 240V AC   |
| Power frequency        | 50 to 60Hz, single phase  |
| Operating temperature  | 5°C to 40°C (40°F to 104°F)   |
| Storage temperature    | -20°C to 60°C (-5°F to 140°F)   |
| Relative humidity      | 5% to 95% RH  |

### Wireless

|                          |   |
|--------------------------|---|
| Wireless standards       | IEEE 802.11ac/n/a 5GHz, IEEE 802.11b/g/n 2.4GHz, simultaneous dual-band   |
| Frequency and data rate  | 2.4GHz: 600Mbps (256-QAM supported), 5GHz: 1300Mbps   |
| Wireless security        | WEP, WPA/WPA2-Personal, WPA/WPA2-Enterprise, Wi-Fi Protected Setup (WPS) 2.0  |
| Other wireless functions | Independent 2.4GHz / 5GHz Wi-Fi schedule On/Off , Guest Network: 2.4GHz / 5GHz<br>3G/4G dongle support (3G/4G dongle is not included) |

### Built-in Features

|                           |   |
|---------------------------|---|
| Operation modes           | Wireless router, wireless AP, wireless client   |
| DHCP                      | Server, client, client list, address reservation  |
| Quality of Service        | Application Layer (L7) Quality of Service (QoS)   |
| Port forwarding           | DMZ, UPnP   |
| Parental control          | Customized Internet schedule, allow / block list, DNS-based web filter with built-in filter database  |
| Traffic control           | Internet ban, custom speed, Traffic Monitor   |
| Network tools             | Ping, Traceroute, Wake on LAN over QuickConnect   |
| Security                  | Firewall / SPI firewall, MAC address filter, denial of service (DoS) protection, auto block, server certificate, Security Advisor, VPN pass-through (PPTP, IPSec, L2TP) |
| VPN client                | PPTP, OpenVPN™, L2TP / IPSec  |
| IPv6 support              | IPv6 DHCP server / client, IPv6 tunneling   |
| Backup options            | Backup & restore SRM configuration  |
| Notifications             | Email, SMS, push notifications (via DS router)  |
| File service              | CIFS, AFP, FTP, WebDAV  |
| FTP server                | Bandwidth control for TCP connections, custom FTP passive port range, anonymous FTP, FTP SSL/TLS and SFTP protocols, transfer logs                                      |
| iOS/Android™ applications | DS router, DS file, DS download   |
| Anywhere access           | Synology QuickConnect, Dynamic DNS (DDNS)   |
| Printer support           | Maximum printer: 1, printing protocols: LPR, CIFS, IPP  |
| Advanced functions        | Static route, Network address translation (NAT), SNMP, SSH, LAN/WLAN IGMP snooping, PPPoE relay   |

## Add-on Packages

|                           |  |
|---------------------------|--|
| VPN Server                | Supported VPN protocols: PPTP, OpenVPN™, L2TP / IPSec, maximum connections: 5                  |
| RADIUS Server             | Provides centralized authentication, authorization, and accounting for wireless network access |
| DNS Server                | Helps user to find, or translate domain names into IP addresses                                |
| Download Station          | Supported download protocols: BT/HTTP/FTP/NZB/eMule, maximum concurrent download task: 50      |
| Media Server (DLNA/UPnP®) | DLNA certified, PS3®/PS4®/Xbox 360®/Xbox One® support, media indexing                          |

## System Requirements

|                    |   |
|--------------------|---|
| Supported clients  | Windows XP onwards, Mac OS X® 10.7 onwards, Ubuntu 12 onwards   |
| Supported browsers | Chrome™, Firefox®, Internet Explorer®: 8 onwards, Safari® 7 onwards, Safari (iOS® 7 onwards on iPad®), Chrome (Android 4.0 onwards on tablets)  |
| Language           | English, Deutsch, Français, Italiano, Español, Dansk, Norsk, Svensk, Nederlands, Русский, Polski, Magyar, Português do Brasil, Português Europeu, Türkçe, Český, 日本語, 한국어, 繁體中文, 简体中文 |

## Environment and Packaging

|                 |   |
|-----------------|---|
| Environment     | RoHS compliant  |
| Package content | RT1900ac main unit, antenna x 3, stand kit, AC power adapter, RJ-45 LAN cable, welcome note |
| Warranty        | 2 years   |

## Connections & Buttons

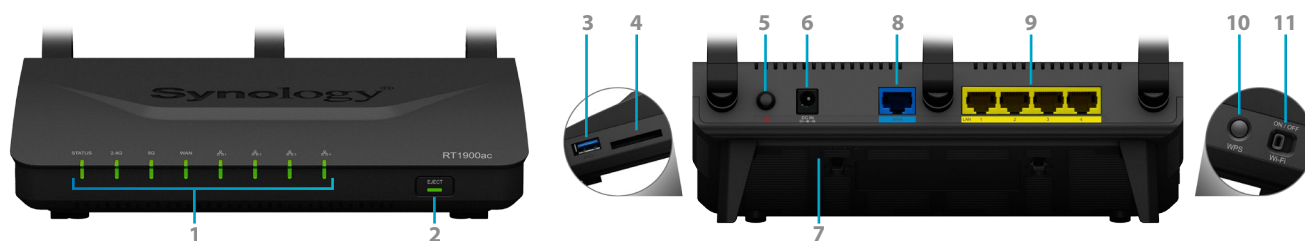

|                 |                       |                        |                  |
|-----------------|-----------------------|------------------------|------------------|
| 1 LED indicator | 2 USB/SD eject button | 3 USB 3.0 port         | 4 SD card reader |
| 5 Power button  | 6 Power port          | 7 Reset button         | 8 WAN port       |
| 9 LAN port      | 10 WPS button         | 11 Wi-Fi On/Off switch |                  |

\*Model specifications are subject to change without notice. Please refer to [www.synology.com](http://www.synology.com) for the latest information.

### SYNOLOGY INC.

Synology is dedicated to taking full advantage of the latest technologies to bring businesses and home users reliable and affordable ways to centralize data storage, simplify data backup, share and sync files across different platforms, access data on-the-go, and networking solutions. Synology aims to deliver products with forward-thinking features and the best in class customer services.

Copyright © 2015, Synology Inc. All rights reserved. Synology, the Synology logo are trademarks or registered trademarks of Synology Inc. Other product and company names mentioned herein may be trademarks of their respective companies. Synology may make changes to specification and product descriptions at anytime, without notice. Printed in Taiwan.

RT1900ac-2015-ENU-REV004

#### Headquarters

Synology Inc. 9F., No.1, Yuandong Rd., Banqiao Dist., New Taipei City 220, Taiwan Tel: +886 2 2955 1814 Fax: +886 2 2955 1884

#### China

Synology Shanghai  
20070, Room 516, No. 638,  
Hengfeng Rd., Zhabei Dist.,  
Shanghai, China

#### France

Synology France SARL  
39 rue Louis Blanc,  
92400 Courbevoie, France  
Tel: +33 1 47 176288

#### North & South America

Synology America Corp.  
3535 Factoria Blvd SE #200,  
Bellevue, WA 98006, USA  
Tel: +1 425 818 1587

#### United Kingdom

Synology UK Ltd.  
Unit C, Denbigh West Business Park,  
Third Avenue, Bletchley,  
Milton Keynes, MK1 1DH, UK  
Tel: +44 1908 366380

#### Germany

Synology GmbH  
Grafenberger Allee 125  
40237 Düsseldorf  
Deutschland  
Tel: +49 211 9666 9666